

## DirecLink– Easy To Install

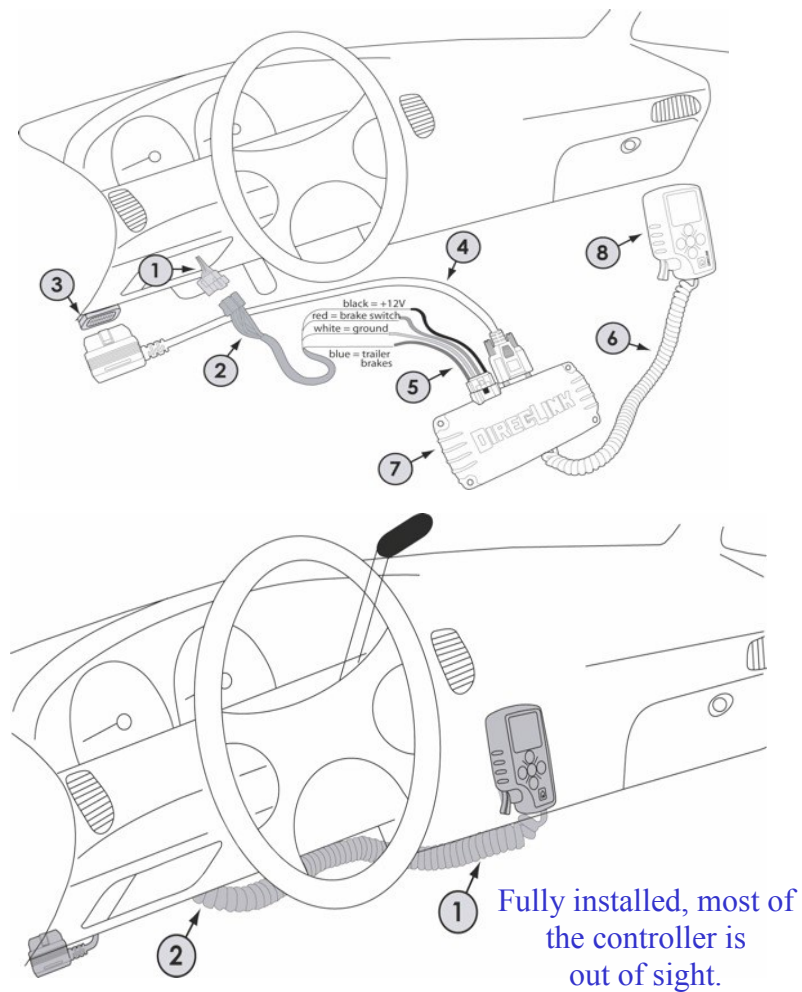

The required electrical connections are indicated by the numbers in the diagram above:

1. Vehicle specific trailer wiring connector (already in vehicle or can be purchased)
2. Vehicle specific trailer wiring harness (must buy separately)
3. Vehicle OBDII connector (already in vehicle)
4. OBDII to DB9 Cable (included with DirecLink)
5. Delphi 4 Wire Harness (included with DirecLink)
6. Spiral Cable (included with DirecLink)
7. DirecLink Control Module
8. DirecLink Command Module

## Three Models

### DirecLink-100

For use with electric drum brakes and all types of electric-hydraulic trailer brake systems

### DirecLink-200NE

NE is the network enhanced version of DirecLink. Can be used with Tuson ActuLink (electric-hydraulic actuator) and ABS system

### DirecLink-50

Tuson RV Brakes is proud to announce the new DirecLink-50 trailer brake controller to be launched in 2017. The DirecLink-50 is a compact, affordable proportional brake controller for use with electric brakes and electric hydraulic brakes.

COMING SOON



For more information about ActuLink Actuator and all of Tuson towble brake products, visit our website

[www.direclink.com](http://www.direclink.com)  
[www.tusonrvbrakes.com](http://www.tusonrvbrakes.com)  
 Tuson RV Brakes, LLC  
 475 Bunker Court  
 Vernon Hills, IL, 60061  
 800-968-8766  
[inforvbrakes@tuson.com](mailto:inforvbrakes@tuson.com)

# DirecLink

## Trailer Brake Controller

### DirecLink-200NE



**TUSON**

Tuson RV Brakes, LLC

The Leader in Towable Safety Technology

# DirecLink-200NE Trailer Brake Controller and Diagnostic Tool

DirecLink NE is the network enhanced version of DirecLink. Can be used with Tuson ActuLink (Electri-Hydraulic Actuator) and Tuson ABS system.

PART NO.	DESCRIPTION	HIGHLIGHT
DL-200NE	For 1 to 4 Axle, Proportional, Trailer Brake Controller	Most Extensive Diagnostics, HD Truck Module Available

- 1-4 Axle Trailer
- Proportional Brake Control, Trailer Size Adjustable
- The Most Extensive Towing Diagnostics Ever
- Can be used with Tuson ActuLink (electric-hydraulic actuator) and ABS system
- Display in Clear Plain Language, incorporated in Large Color Display
- Plug & Play, Humanized Design features make DirecLink easy to install and use
- Automatically Configures to your Tow Vehicle
- Automatically Configures to your Trailer Brake System
- Limit Lifetime Warranty

## Tuson ABS Module

greatly improves vehicle stability during braking by maintaining high levels of rolling resistance braking and preventing tire lock-up. This is especially true on wet pavement when tire lock-up can readily occur. When trailer tires lock up, the trailer can easily slide to the side. The ActuLink ABS Module keeps the trailer tracking straight behind the tow vehicle.

## DirecLink-200NE

### The Most Extensive Towing Diagnostics Ever

- Trailer Connection
- Tow Vehicle Battery Voltage
- OBDII Network Connection Integrity
- Brake Controller Ground Connection
- Brake Controller Power Connection
- Brake Switch Voltage
- Blue Wire Voltage Output
- Blue Wire Current Output
- Blue Wire Short
- Ground Connection to Trailer
- Tow Vehicle-Towable Data Network Integrity
- Trailer Battery Volt Level Under Load
- Trailer Battery Amp Level Under Load
- ActuLink Brake Fluid Level
- ActuLink Temperature Level
- ActuLink Over-Current Condition
- ActuLink Low Voltage Condition
- ActuLink ABS Module Connection Integrity
- Trailer ABS Sensor Integrity (4 Sensors)
- Trailer ABS Module Valve Integrity (8 Valves)
- Trailer Tire Inflation Warnings (4 Tires)
- Engine RPM
- Transmission Temperature (Ford & GM)

## Tuson ActuLink Electric-Hydraulic

has many one of a kind features which place it in a new class of brake actuator. But the feature which makes it truly revolutionary is that it is networked with your tow vehicle so it has the ability to brake in a collaborative way. The DirecLink Network puts the ActuLink well above and beyond the competition.

## Two-way Digital Data Network



## Patented Digital Data Network

DirecLink NE, when used in combination with the ActuLink actuator, automatically creates a digital, two-way data network over the existing wires of your tow vehicle and towable. DirecLink NE lets you monitor the status of your towable brake system like never before.

## Data and System Integrity

DirecLink NE's data network sends braking data in a digital format to the ActuLink actuator and this information is verified with each rapid exchange of data. The DirecLink NE also monitors electrical connection and sensor data integrity to ensure the driver knows the exact status of the towable brake system.

## Peace Of Mind With Diagnostics

DirecLink NE automatically displays an alert on its color screen to warn you of any system faults or failures. DirecLink NE's diagnostics assure you all is well, or give you the information you need to resolve a problem.

## Color Display

The large color display makes it easy to use the DirecLink NE as a diagnostic tool for your towable brake system to ensure that all systems are good or to resolve any problems.



## DirecLink Brake Controller Works with:

**1997 to Present**  
Ford  
General Motors  
Chrysler

**2008 to Present**  
Nissan  
Toyota  
Mercedes-Benz  
Volkswagen

## HD Truck Module Now Available for

Peterbilt  
Freightliner  
Kenworth  
International  
Volvo  
and others.

(For DL-100, 200NE ONLY)